



CHATEAU  
LACOMBE  
HOTEL  
"unique by nature"



**C**entrally located in the heart of downtown, the locally-owned and iconic Chateau Lacombe offers spectacular scenic views of the North Saskatchewan River Valley and Edmonton's cityscape. Experience Edmonton at its finest, minutes from the Ice District and Rogers Place and walking distance to the Edmonton Convention Centre, government and corporate offices, Light Rail Transit (LRT), Arts District, City Centre Shopping Mall, entertainment and nightlife. With 307 guestrooms and 14,000 square feet of banquet space, the Chateau Lacombe is a perfect venue for your meetings small and large, conference and special events.

## ACCOMMODATIONS

- 307 Guestrooms & Suites
- Designated Quiet Zones
- 32" Flatscreen TV's
- Telephones with Voicemail
- Complimentary High Speed Internet
- In-Room Dining
- Pay-per-view Movies
- In-Room Coffee/Tea
- Hair Dryer
- Iron & Ironing Board

## GUEST SERVICES

- Complimentary High Speed Internet throughout the hotel
- Valet Parking
- Self Parking
- Dry Cleaning/Laundry Service
- 24-hour Business Centre
- 24-Hour Fitness Centre
- Town Car Service
- Concierge Service
- Safety Deposit Boxes
- Multi-Lingual Staff
- Check-In 4:00 PM
- Check-Out 12:00 PM
- Express Check-Out

## WHERE TO DINE

**LA RONDE** - Edmonton's only revolving restaurant. Located on the 24th floor, La Ronde is the city's premier fine dining restaurant and most popular Sunday Brunch destination, with incredible panoramic views of the North Saskatchewan River and Edmonton's cityscape. Join our culinary team in a celebration of fine wine, regional cuisine and exceptional service for an unmatched dining experience

**BELLAMY'S LOUNGE** - Overlooking the river valley, Bellamy's is a great place to relax and unwind. Featuring a fine selection of single malt scotch and local draught beers.

**CAFÉ LACOMBE** - Downtown Edmonton's most scenic breakfast location, offering a sumptuous full breakfast buffet. Book Café Lacombe for your own private dinner party up to 120 people.

LOBBY LEVEL	DIMENSIONS	SQUARE FEET	CEILING HEIGHT	CLASSROOM	THEATRE	U-SHAPE HOLLOW SQ.	BOARDROOM	RECEPTION	BANQUET	DANCE FLOOR
Alberta Ballroom Salons A, B, C & Foyer	----	8786	14	570	1000	n/a	n/a	1000	550	33 x 42
Salons A & B	79 x 74	5846	14	340	700	n/a	n/a	760	340	33 x 42
Salon A	49 x 74	3626	14	215	500	110	80	450	250	33 x 31
Salon B	29 x 74	2146	14	135	280	100	65	270	150	n/a
Salon C	19 x 60	1140	9	60	100	45	32	120	60	n/a
Foyer	30 x 60	1800	9	100	200	45	40	200	n/a	n/a
Salon C & Foyer	60 x 44	2940	9	125	300	n/a	n/a	330	175	n/a
Lacombe	19 x 60	1140	9	50	100	45	40	120	64	n/a
River Valley A & B	30 x 30	900	9	32	60	25	24	80	40	n/a
River Valley A	15 x 30	450	9	18	30	n/a	12	45	20	n/a
River Valley B	15 x 30	450	9	18	30	n/a	12	45	20	n/a
THIRD FLOOR										
Klondike A & B	22 x 73	1560	9	70	100	48	44	180	100	12 x 16
Klondike A	22 x 36	780	9	32	50	24	22	85	40	n/a
Klondike B	22 x 36	780	9	32	50	24	22	85	40	n/a
McDougall	22 x 36	780	9	32	50	24	22	85	40	n/a
Strathcona	22 x 36	780	9	32	50	24	22	85	40	n/a
Beaver	22 x 23	520	9	n/a	n/a	n/a	10	n/a	n/a	n/a
Boardroom	14 x 14	196	9	n/a	n/a	n/a	8	n/a	n/a	n/a

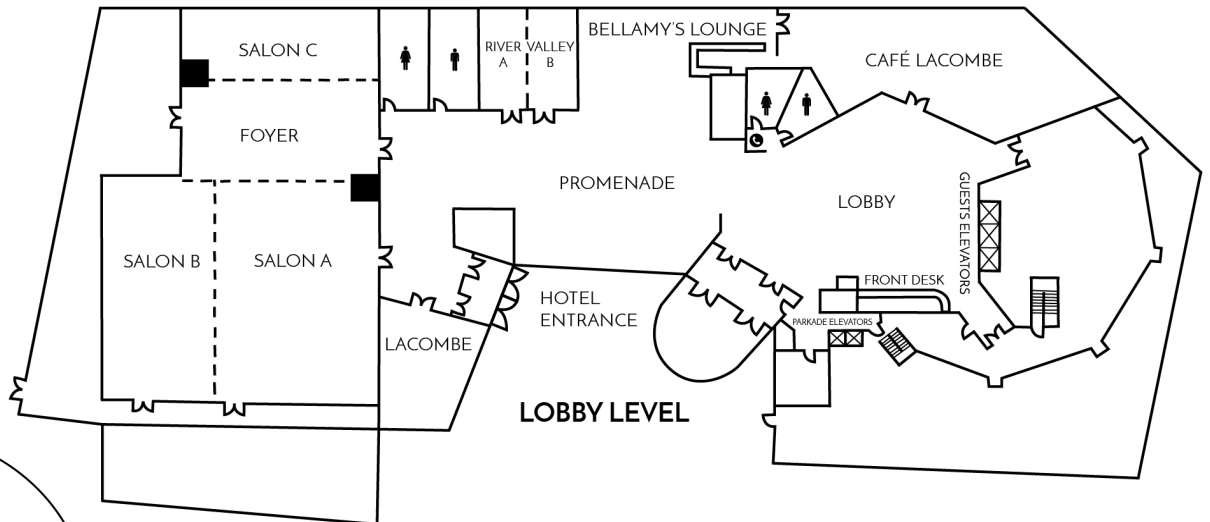

## MEETING & SPECIAL EVENTS

Offering 14,000 square feet of meeting and banquet space and home to the second largest ballroom in downtown Edmonton, our facilities offer options for every occasion. Whether you need a beautiful location for your special day, or a relaxed, upscale environment for your next meeting or presentation, we have the room for you. For a memorable and successful meeting or event, at the Chateau Lacombe, our main focus is you.

### THIRD FLOOR